

FORM NO 1.

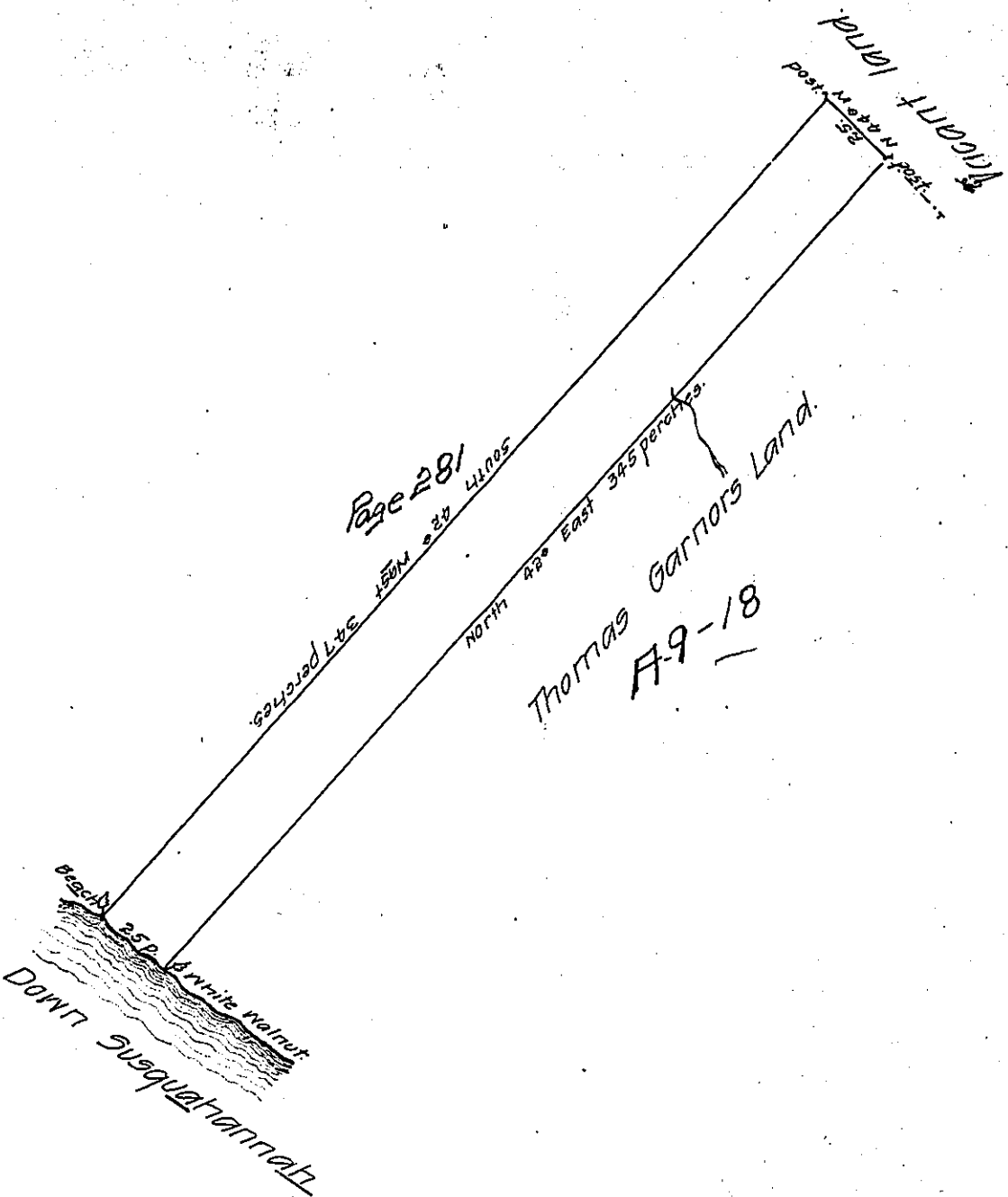

By virtue of the Proprietors order dated the 20th of Feb^y Anno Domini 1737
 Surveyed on the 9th day of March 1737 To the Honourable the Proprietors
 use for a Ferry, A tract of land situate in the Township of Paxtang in the
 County of Lancaster Beginning at a white Walnut Thence north 42° Degrees
 East 345 perches to a post Thence north 44° degrees West 25 perches to a
 post Thence south 42° degrees West 347 perches to a beach, Thence down
 Susquehanna River 25 perches to the place of Beginning Containing
 fifty one acres and the allowance of six acres & Cent for roads &
 highways

Surveyed P Me
 Edⁿ. Smout

IN TESTIMONY that the above is a copy of the original remaining on file in
 the Department of Internal Affairs of Pennsylvania, made
 conformably to an Act of Assembly approved the 16th day of
 February, 1833, I have hereunto set my Hand and caused
 the Seal of said Department to be affixed at Harrisburg,
 this sixteenth day of March 1910.

Henry Howell
 Secretary of Internal Affairs.